

C-70CA52 EXPLODED VIEW

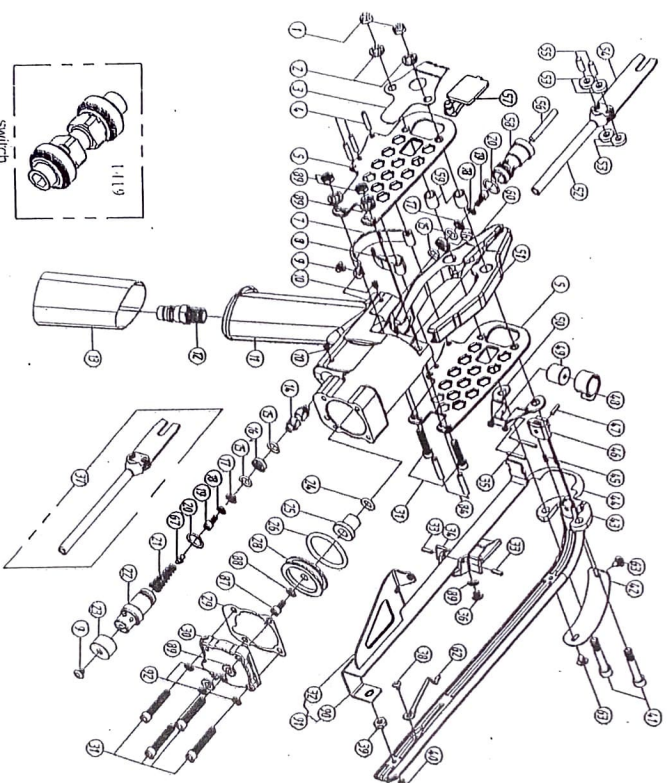

EXPLODED VIEW

QTY	DESCRIPTION	QTY	DESCRIPTION	QTY	DESCRIPTION
1	1/4" NUT	38	SCREW	1	M4X8
2	WASHER, JAW BOLT	39	JAW BOLT	1	M5
3	LATCH	40	Down from bar-bolt	1	M5X12
4	PIV	41	BOLT, Jaw	2	M6X36X25
5	SPRING PLATE	42	BOLT	1	--
7	ROUND TRIGGER	43	JUXTATING SPRING	1	--
8	TRIGGER	44	SPRING, Repetition	1	--
9	Down from bar-bolt	45	SPRING, Shim	2	--
10	SCREW SET	46	SPRING, Repetition	1	--
11	BUSHING, MOUNTED	47	PIV BOLT	1	φ2.5X12
12	FLAT	48	SPRING, Rubber	1	--
13	CAIP	49	BALL, Feed cone	1	--
14	SPRING, Hammer valve	50	SHOCK, Spring	1	--
15	O RING	51	JAW, Upper	1	--
16	SPRING, Ring counter	52	SPRING, Shim	1	--
17	SPRING, Ring end	53	WASHER	4	--
18	ROCKER, Inertive valve	54	BOLT, Retarder	1	--
19	SCREW	55	PIV, Ball	2	φ5X12.5
20	O RING	56	SPRING, Hammer	1	--
21	SPRING VALVE	57	WASHER	1	--
22	SEAT, REAR VALVE	58	SPRING, From valve	1	--
23	REPLACES AIR	59	WASHER, Jaw	2	--
24	O RING	60	JAW, Lower	1	--
25	REPAIRING Piston rod	61	--	1	--
26	O RING	62	WASHER, punch	1	--
27	--	63	SCREW	2	M4X8
28	PISTON	67	BEAD, SPRING	1	--
29	WASHER	84	Down Pin	2	φ4x18
30	CP	85	SPRING, Shim	2	M5
31	SCREW	87	SCREW	1	M6X16
32	Pin, neck	88	WASHER	5	φ5
33	PIV, ball	89	WASHER	1	φ6
34	ROCKER, Finished	90	ROCKER, Finished	1	--
35	PIV, BALL	91	ROCKER, Finished	1	--
36	Down from bar-bolt	92	WASHER	4	φ5
37	ROCKER, Assembly			1	--

L419 HAMMILL ASSEMBLY